

# EAB series

Reservoir Equipment

## Mounting instructions

### Threaded connection

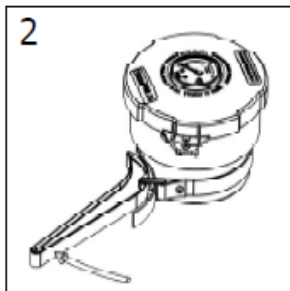
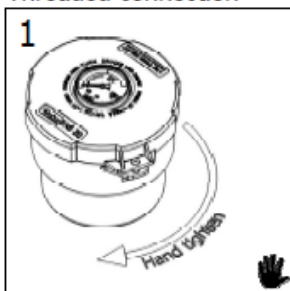

Instructions:

- Step 1  
- Screw on the EAB breather hand tight
- Step 2  
- Use a strap wrench to turn and tighten the EAB breather:
- For metal connectors:  $90^{\circ} \pm 5^{\circ}$
  - For plastic connectors:  $180^{\circ} \pm 5^{\circ}$

### 6-hole fixing

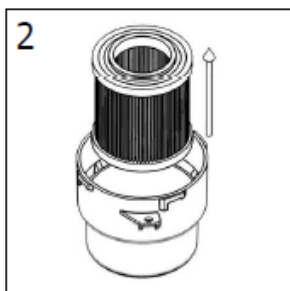
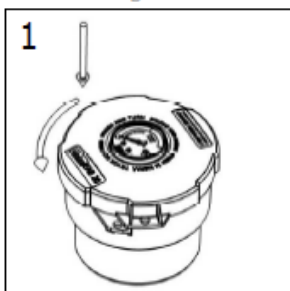

Instructions:

- Step 1  
- Push and turn counter clockwise to remove cover
- Step 2  
- Take out the element
- Step 3  
- If needed: Place strainer and gaskets  
Insert screws (6x) to affix EAB breather
- Step 4  
- Insert element and replace cover

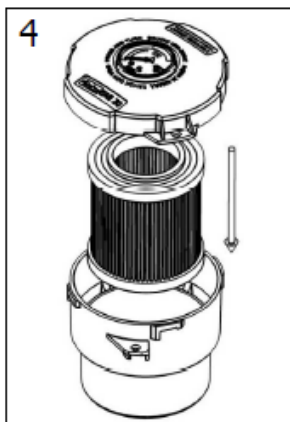
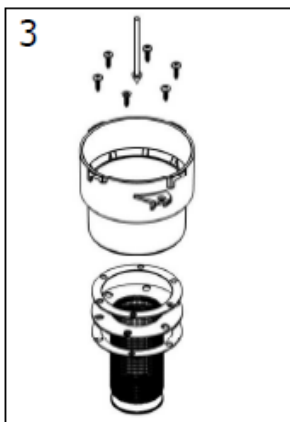

# EAB series

Reservoir Equipment

## Element replacement instructions

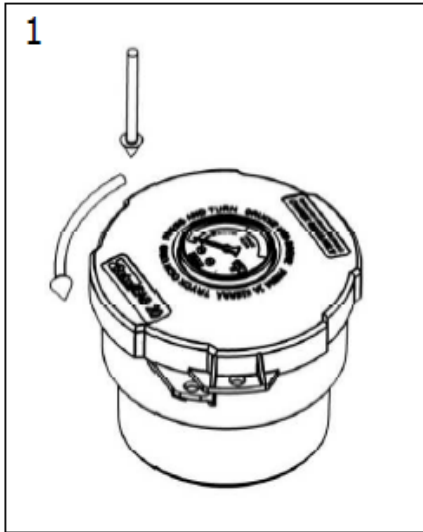

Instructions:

Step 1

- Push and turn counter clockwise to remove cover

Step 2

- Take out element

Step 3

- Insert new element and replace cover

